



Luxury has a
new name



Luxurious Apartment you *ever dreamt of...*

Most sought after and prestigious address of Jaipur



Luxurious Apartment you *ever dreamt of...*

A wonderful life awaits you!

A Smart deal

Come home to the future...

Shivleela Raj is a Ultra Premium Luxury Boutique Residential Apartments situated at Jaipur's most prestigious address Sardar Patel Marg, C-Scheme, Jaipur. **Shivleela Raj** comprising **12 premium apartments**. **Shivleela Raj** has airy bedrooms, captivating sit-outs, smartly planned kitchen ensure your family's happiness. step into the world of the future! wonderfully spacious intelligently designed



Your gateway to *fine living*...



Inspired by the preciousness of "**Kohinoor**" in every sense

Legend says the "**Kohinoor**" diamond was in the crown of Yudhister the eldest Pandavas. It was inherited by king Anandpal-II Tanwar of Gwalior. Following several battles, it exchanged several hands and finally after 1857 "**Kohinoor**" came in the possession of Queen Victoria of England. The owner of "**Shivleela**" is proud of her Tanwar inheritance and has provided her inputs in the development of "**Shivleela Raj**" to reflect preciousness and pureness in planning to enhance your comfort and luxury like "**Kohinoor**"

Your home should give you a feeling of space

The doors and windows should create a path for the wind to travel and for the sun and moon to light up your home. The walls and security measures should give you a feeling of safety and comfort. Your home should harmonise with the elements and it should let you set up this harmony in your own individual way. When you know that you are living in a home that gives you all this, rest assured that it's a dream home. Like the one you have at **Shivleela Raj**.



Luxurious Apartment you *ever dreamt of*...





Luxurious Apartment you ever dreamt of...



Perhaps the most charming *home of your dream...*



Luxurious Apartment you ever dreamt of...



We are building homes that uphold your pride

Following the unprecedented success of back to back projects, Pachar Group is proud to announce its flagship project **Shivleela Raj** at Sardar Patel Marg, C-Scheme, Jaipur. A 9 Story super luxury apartment project strategically located in the most sought after residential location with in the city

Own your very own *piece of heaven*

3 & 4 BHK Super Luxury Apartments

Welcome to a *world of leisure...*



Luxurious Apartment you ever dreamt of...



Unwind yourself @ well equipped club house

Rejuvenate your senses at the Club House after a hard day's work or spend quality time with the family sitting by the pool side in sunny afternoon. Take a pick from a relaxing yoga and meditation pavillion, gym with separate area for weights, cardio and aerobics or indoor games. You are sure to indulge yourself in these fine luxuries. Look around you and enjoy the sweet moments life brings to you at **Shivleela Raj**

Swimming Pool | Gym



Stilt Floor Plan



First Floor Plan



Option-I

FLOOR AREA SCHEDULE

FLAT No.	Super Built-up Area (sq.ft.)
201, 301, 401	3245
202, 302, 402	3560
Built-up Area = Less 25%	



Option-II

Second to Fourth Floor Plan

Option-I



FLOOR AREA SCHEDULE

FLAT No.	Super Built-up Area (sq.ft.)
501, 601, 701, 801	6805

Built-up Area = Less 25%



Option-II



Fifth to Eight Floor Plan



Crafted with *excellence*

Luxurious Apartment you ever dreamt of...

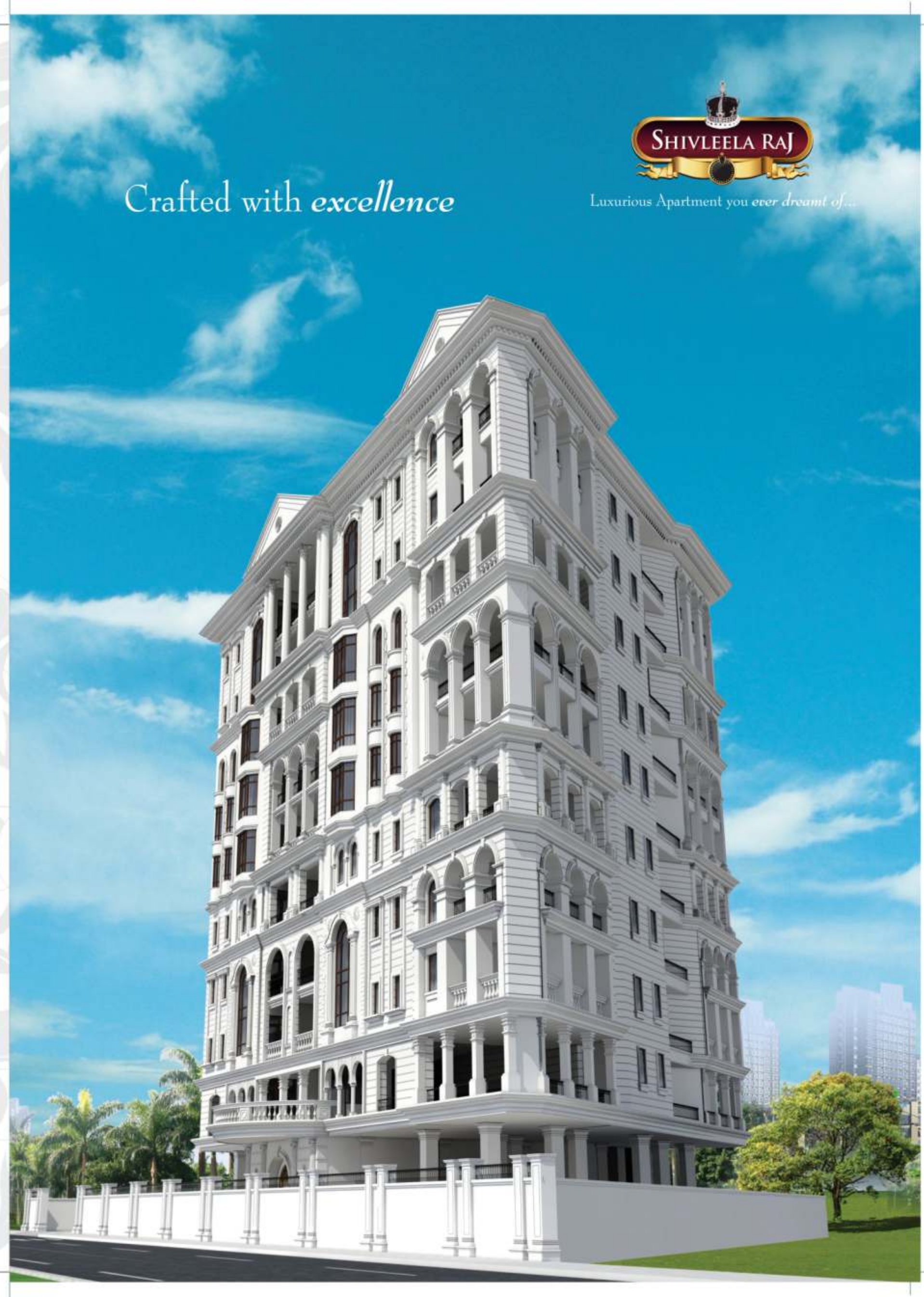



FLOOR AREA SCHEDULE

	Lower Pent House	Upper Pent House		Terrace
FLAT No.	Super Built-up Area (sq.ft.)	Super Built-up Area (sq.ft.)	Total (sq.ft.)	Total (sq.ft.)
901	3245	510	3755	1890
902	3560	510	4070	2150

Built-up Area = Less 25%

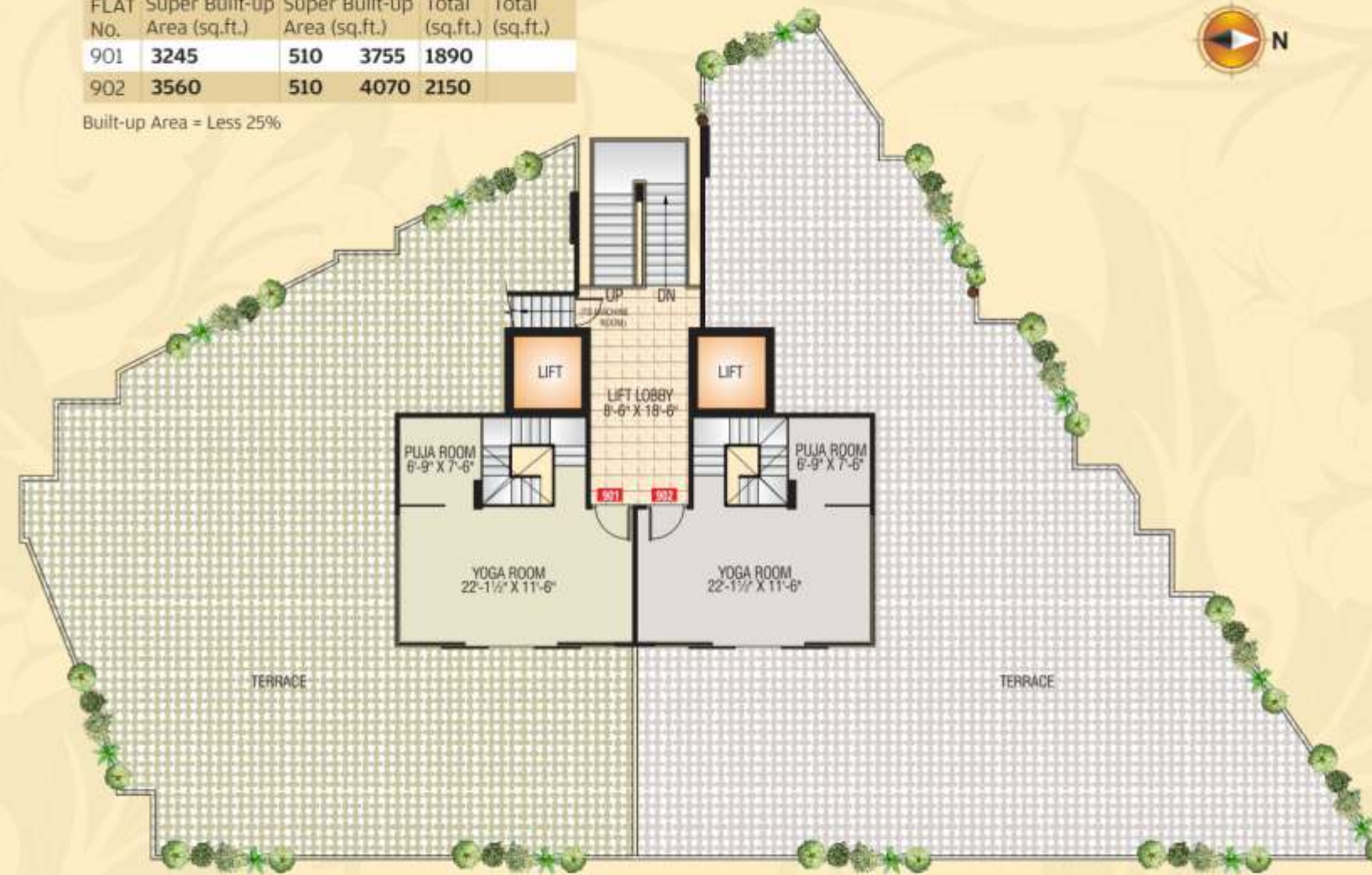

Ninth Floor Plan

Salient Feature

Structure

- Earthquake resistant framed structure design as per Seismic Zone II.

Apartment Features

- Granite, Italian Marble Flooring in Drawing and Dining area.
- POP finish on wall & ceiling with cornices.
- Acrylic Plastic paint on wall & ceiling.
- Polish/Paint on doors & windows.

Wood Work

- Windows having Glass panels/wire mesh panels
- Tough ISI mark 30 mm flush doors.
- Well designed main door of 30 mm thickness.
- Brass fitting of good quality on doors & windows.

Kitchen

- Granite working counters, SS sink.
- 2' tiles dado above the counter.
- Modular Kitchen.
- Separate Washing Area.

Toilet

- Cubicle shower/Panel in master bedroom.
- Designer tile in toilet.



- Premium C.P. Fitting of Crabtree/Marc/Jaquer Continental Range.
- Ceramic tiles in toilet upto 7' height on walls.
- Anti-skid ceramic tiles on flooring.
- Counter wash basin in master Bedroom toilet.



Security System

- Closed Circuit TV (in Entrance lobby/Parking area).
- EPBX system.
- Well managed Security Service.



Electrical

- Modern electrical system with concealed Copper Wiring.
- Premium quality Switches & Accessories.
- TV/Telephone/A.C. point in all the rooms at appropriate places.
- Power backup (Silent D.G. Set) for common service.



General Features

- Well designed Entrance foyer & Lobby area.
- Appropriate fire fighting arrangements.
- 2 Lifts for fast & easy commuting.
- 24 hour water supply through own tubewell.
- Rain water harvesting system.
- Swimming Pool + Club House on First Floor



Luxurious Apartment you ever dreamt of...



Luxurious Apartment you ever dreamt of...



The Group

"Yatto Dharma Stato Jai," which means that "True victory always follows if you are on the right path of Dharma" is the business philosophy and motto of the Pachar Group. Keeping this principle in practice the erstwhile royal family of Pachar commences operations in the year 1982.

With a philosophy that the true victory always follows, if you are on the right path of Dharma, Pachar Group entered into the real estate business with the motto "we build trust" that represents responsibility, purpose, faith and greater collective satisfaction to achieve the common goals. Our symbol and philosophy speak about our devotion and commitment towards the development of the Nation and betterment of our valued customer.

Pachar group started its hotel operations in 1995, by converting their ancestral palace at Pachar, Shekhawati, Rajasthan into a Heritage Hotel, known as Castle Pachar. Besides, operating a Heritage Hotel at Jaipur known as Hari Mahal Palace. Now the group is coming up with Aaram Mahal real Brand of hotels all over Rajasthan.

The group is committed towards promoting rural tourism and preserving splendour of heritage as their corporate social responsibility.



Builders & Developers

Pachar Group

F-6, Tirth Raj Apartment, Jacob Road, Civil Lines, Jaipur - 302 006
 Ph.: 0141-2222254, Mob. : 098290 51297 Fax.: 0141-2226920
 Web Site : www.pachargroup.com, email : info@pachargroup.com



Architect

SHEKHAWAT & ASSOCIATES ARCHITECTS PVT. LTD.

124, Himmat Nagar, Tonk Road, Jaipur - 302018
 Tel. : 0141-2706227, 2712377, 2705580
 Website : www.ideasjaipur.com
 E-mail : ideasjaipur@gmail.com

Disclaimer: This Brochure is purely conceptual and not a legal offering. Further the Promoters/Architect reserve the right to add/delete/ modify any details/specifications/elevation mentioned here in.

The first part of the document discusses the importance of maintaining accurate records in a laboratory setting. It emphasizes the need for clear labeling and organization of samples and reagents. The second part details the procedures for handling hazardous materials, including the use of personal protective equipment and proper disposal methods. The third part covers the calibration and maintenance of laboratory instruments, ensuring that all measurements are precise and reliable. The final part of the document provides a checklist for routine laboratory safety checks, including fire drills and emergency response protocols.